



Roland Mews, Stepney Green, London, E1

BUTLER & STAG





**Situated by the tranquil and leafy Stepney Green is this two bedroomed mews house, offering great light and space throughout, set in a secure private close.**



- Two Double Bedrooms
- Private Patio
- Conversion Property
- Walking Distance to Stepney Green Station
- Mews House
- Secluded Private Location
- Close to Stepney Green
- Available Now

Welcome to Roland Mews, Stepney Green - a charming location that could be your next home sweet home! This delightful mid-terrace house boasts a modern kitchen, perfect for whipping up your favourite dishes, and a cosy reception room ideal for relaxing or entertaining guests. With two double bedrooms, there's plenty of space for a couple or for those who enjoy having a guest room or home office.

Step outside to your very own small private patio area, where you can enjoy a morning coffee or unwind after a long day. The property, a former Scouts Hall sympathetically converted into a period-style house, exudes character and history while offering all the modern conveniences you could desire.

Built in 2000, this 797 sq. ft home features two double bedrooms, providing ample space for rest and relaxation. If you're looking for a rental property or a place to call your own, this mews house offers a unique opportunity to live in a vibrant East London neighbourhood.

Don't miss out on the chance to make this house your own - schedule a viewing today and envision the possibilities that await you at Roland Mews!









## Roland Mews

Approx. Gross Internal Area 73.4 sq. metres ( 789.8 sq. feet)

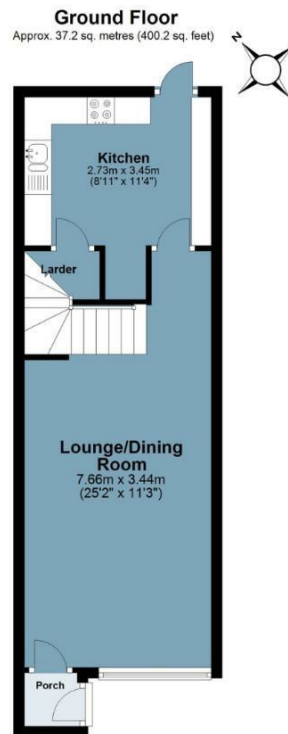

**BUTLER & STAG**

**First Floor**  
Approx. 36.2 sq. metres (389.7 sq. feet)

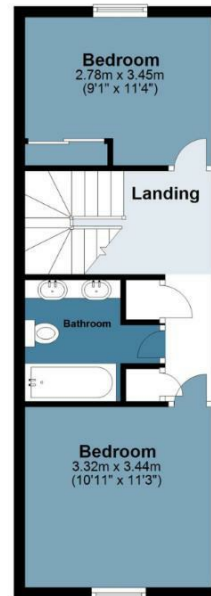

Measurements are approximate and for illustration purposes only. While we do not doubt the accuracy and completeness, we advise you conduct a careful independent assessment of the property to determine monetary value  
© @modephotouk www.modephoto.co.uk

IMPORTANT NOTICE - These particulars have been prepared in good faith and they are not intended to constitute part of an offer or contract. We have not performed a structural survey on this property and the services, appliances and specific fittings have not been tested. All photographs, measurements, floor plans and distances referred to are given as a guide and should not be relied upon.

**BUTLER & STAG**

☎ 020 8102 1236

🏠 508 Roman Road, Bow, London, E3 5LU

✉ bow@butlerandstag.com

[www.butlerandstag.uk](http://www.butlerandstag.uk)